

## Commissioning

- The ceiling surface must be flat and smooth to ensure a good fit.
- Push the spring clips upwards and fit into the ceiling hole. See Fig 1.
- Push the unit up until firmly in position, ensuring that no cables are trapped. See Fig 2.
- Ensure that the product is sitting properly in the hole.
- Replace fuse or circuit breaker and switch on. Your light is now ready for use.
- **This product is suitable for dimming. Just Dimmable with "SaxbySmart App". Please refer to the "SaxbySmart" manual for specific operations.**

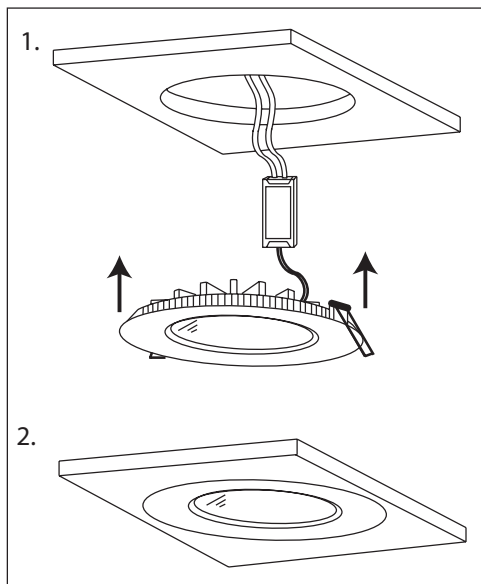

## Fitting/replacing bulbs

- This product contains non replaceable parts and cannot be serviced.

- We recommend cleaning with a soft dry cloth. Do not use solvents or abrasive cleaners as these could damage the finish.

## Recycling advice

-  Waste electrical products should not be disposed of with household waste. Please recycle where facilities exist. Check with your Local Authority or retailer for recycling advice.

## Safety information

For your safety, always switch off the power supply before cleaning.

## Instruction leaflet

# Orbital Smart Tunable Downlight

79305



CE

saxby  
lighting

Thank you for purchasing this light fitting. Please read the instructions carefully before use to ensure safe and satisfactory operation of this product. Please retain these instructions for future reference.

## Warning

**This light fitting is Double Insulated and does not require connection to an Earth circuit.**

Please read these instructions carefully before commencing any work.

This unit must be fitted by a competent and qualified electrician.

Install in accordance with IEE Wiring regulations and current Building Regulations.

This system operates at Safety Extra Low Voltage, via the supplied LED driver. Never connect the light fittings directly to the mains without using the supplied LED driver.

Always disconnect the LED driver from the mains when installing or maintaining this system.



Luminaires not suitable for covering with thermally insulating material.

To prevent electrocution switch off at mains supply before installing or maintaining this fitting. Ensure other persons cannot restore the electrical supply without your knowledge.

This light fitting should be connected to a fused circuit.

If replacing an existing fitting, make a careful note of the connections.

This fitting must always be fitted to a plasterboard ceiling. This must not be fitted to a plaster and lathe ceiling

This system contains non-replaceable parts and cannot be serviced. If damage occurs the part should be scrapped.

This product meets the electrical installation requirements for fire-rated ceiling lamps (BS476 Part 21) and can withstand fire up to 30, 60 and 90 minutes.

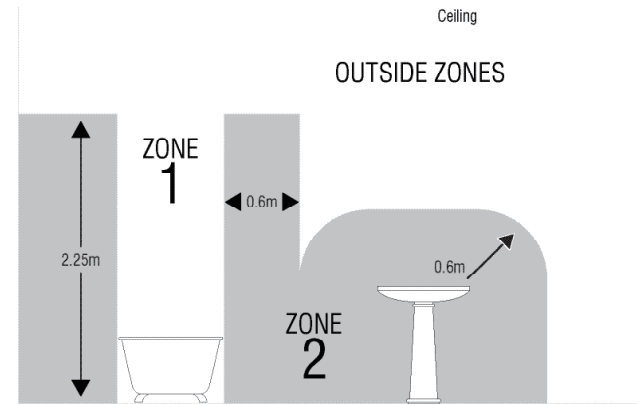

This product is suitable for use in Zone 2 and outside Zones of a bathroom. See diagram. If this unit is being fitted in a room containing a bath or shower, a 30mA RCD must be used, in accordance with IEE regulations.

## Installation

Existing fittings must be completely removed before installation of a new product. Before removing the existing fitting, **carefully note the position of each set of wires.**

- Position the LED Driver next to the mains outlet that the system will connect to. Do not connect at this stage.
- Cut a 97mm diameter hole using an appropriate tool.

- Ensure that the void depth is a minimum of 75mm.
- It is recommended to cut the hole slightly smaller than needed, then file the hole until the recessed unit fits snugly.

## Wiring

Having correctly identified the wiring from your existing light fitting, pull the wire through the hole and connect to the connection block inside the LED driver in the following way:

This unit is double insulated and must not be earthed. If there are any incoming earth cables, they must be joined together and well insulated with good quality insulation tape. This is to ensure earth continuity throughout your property.

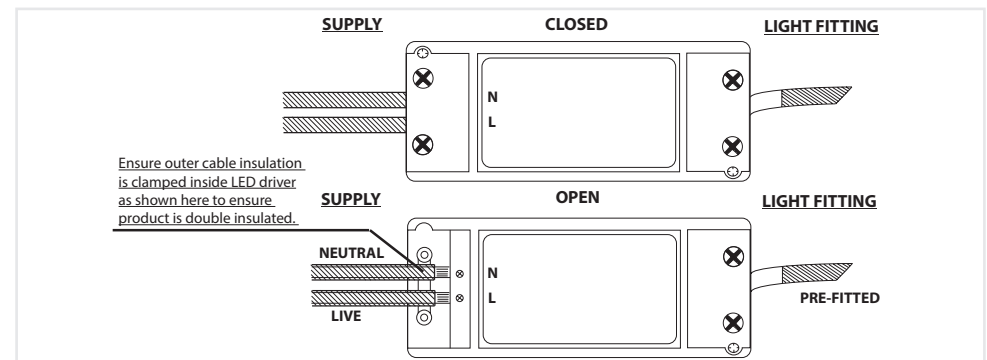

## Check that...

- You have correctly identified the wires.
- The connections are tight.
- No loose strands have been left out of the connection block.

## Specification

Voltage: 240V 50Hz  
Lamp: 9W LED Module (CCT) 3000K-6000K  
IP Rating: 65

## Layout

- Plan the desired layout of these fittings carefully, ensuring the cables will reach the distances between the transformer and each light fitting.
- Avoid locating any cables in positions that would cause a hazard. Position cables and junction boxes (not supplied) away from areas where they may be at risk from being cut, trapped or damaged.
- The mains supply cable must have a minimum cross sectional area of 1.0mm<sup>2</sup>.
- The distance between units must be 0.5m minimum.
- The unit must be located 0.2m away from a joist.
- This product must be mounted out of arms reach.
- The luminaire/fitting can be installed with insulation.
- Driver can be covered with insulation no ventilation required.

INTELLIGENT LIGHTING

# saxby**smart**

## User Manual



## STEP 1

Scan the QR code to download the App. Log in to Google Play or the App Store on your mobile phone. Search 'Saxby Smart' and click 'Download'. You will need an active internet connection. Once downloaded, click on the app to open and proceed to log in or register.



App Store



Google Play

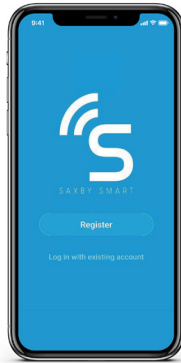

## STEP 2

Please read carefully through the Privacy Policy. You may click 'Agree' to proceed with set up. Or click 'Disagree' if you wish to cancel registration.

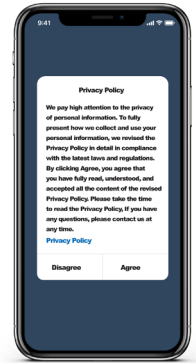

## STEP 3

After clicking 'register' you can choose to set up your account by phone or email. Enter your email address or mobile phone number into the dedicated fields and proceed to accept the service agreement and privacy policy by ticking the box. Click 'Obtain verification code'. A text message or email will be with you shortly to confirm your verification code.

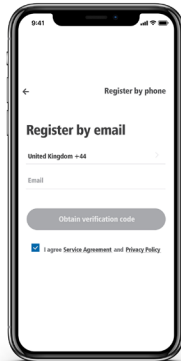

## STEP 4

Enter the verification code that was sent to you via email or text message in the dedicated field. Please note, the field automatically spaces your code into six easy to read sections. You can also resend the code here if you haven't received it yet. Please allow up to five minutes for your code to be received.

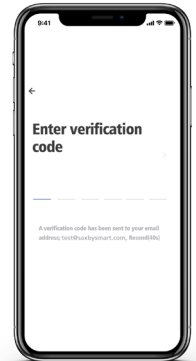

Please note: Saxby Smart products will support 2.4G WiFi bands only

## STEP 5

Nearly there.

All you need to do now is set a password for registration. Please note, that your password needs to be a combination of letters and at least one number and between 6-20 characters long.

You may click the eye icon to view your password to verify it is correct before clicking 'Completed'.

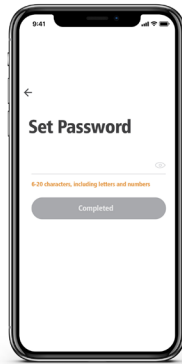

## STEP 6

Welcome to Saxby Smart.

Please click 'Create family' to turn on your smart life.

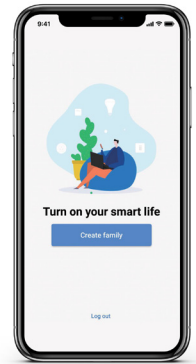

## STEP 7

Enter an easy to remember name for your family/household like 'Smiths family'.

You can tick or untick rooms depending on your property. Any rooms to add that are not on the list? Click 'Add another room' to set up as many additional rooms as you wish, e.g. conservatory.

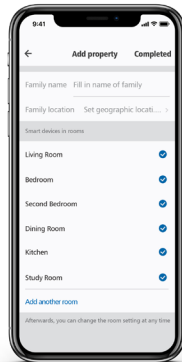

## STEP 8

It is now time to add your smart light fittings.

Click 'Add device'.

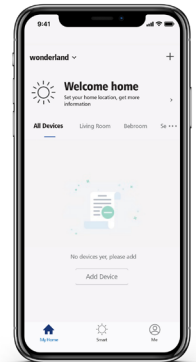

## STEP 9

Here we will pair your lights with your App.

Turn the lights on, leave it for 10 seconds.

Turn it off and on repeatedly, three times.

When the lights start to blink, click 'Confirm light blinks rapidly'. This pairs your lights and App.

Please install one light at a time.

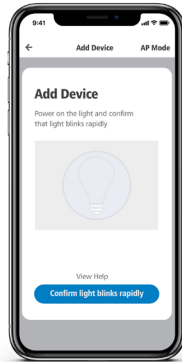

## STEP 10

Enter your WiFi details and click 'Confirm'.

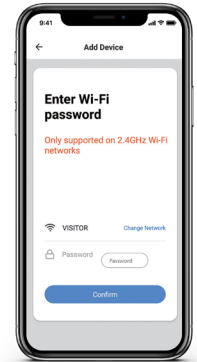

## STEP 11

The app will now connect your fitting.

Once the process is 100% completed, the 'Added successfully' page will show your device.

You can keep the default product name (e.g. Orbital Smart) or rename the device.

Rename the device if adding multiples.

Finally click 'Completed'.

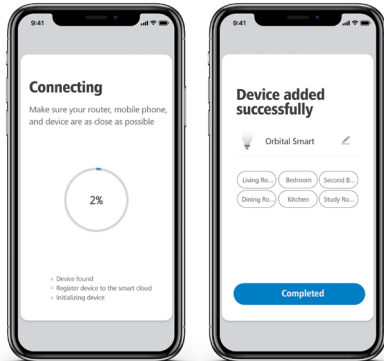

## STEP 12

You're good to go and ready to control your fitting through your smartphone. Click 'White mode' to adjust the colour temperature and brightness or click 'Schedule' to set up a day by day planner for your lights.

Click the triple dot icon at the top right corner to display extra options, such as pairing your fitting with Amazon Alexa or Google Assistant.



## CONNECTING TO GOOGLE HOME

Open your Google Home App.

Click Home Control and the + button to add device.

Search 'Smart Life'.

Enter the same log in details used for your Saxby Smart App.

Assign your light to a room.

Your light is now set up. Try a voice command like "Hey Google, turn off the light."



## CONNECTING TO AMAZON ALEXA

Open your Alexa App.

Click Skills & Games.

Search 'Smart Life' and click 'Enable to use'.

Enter the same log in details used for your Saxby Smart App.

Alexa will now discover and connect your devices.

Your light is now set up. Try a voice command like "Alexa, turn off the light."

